

# solar**edge**

## SolarEdge Home Load Controller for SG Ready use

For inverters with SetApp  
configuration

For Europe

Version 1.4

[Datasheet](#)

[Training](#)

[Application Note](#)

- EN Quick Installation Guide
- DE Schnellinstallationsanleitung
- NL Snelle installatiegids
- FR Guide d'installation rapide
- IT Guida rapida all'installazione
- ES Guía de Instalación Rápida
- PL Skrócona instrukcja instalacji
- CZ Stručný návod k instalaci
- HU Gyors telepítési útmutató
- BR Guia de instalação rápida
- SV Snabbinstallationsguide
- SL Hitra navodila za namestitev



### System Requirements and Safety Information

#### System Requirements

- SolarEdge SetApp to connect to the inverter and upgrade firmware
- mySolarEdge to configure and read status
- iOS 10 or later or Android 6.0.1 or higher

#### Installation Placement Requirements

- The load controller is for indoor use only.
- To ensure correct operation, mount the Load Controller on the wall or in a cabinet.



#### Safety Information

- For indoor use only
- Keep children away from the device
- DO NOT use with medical or life support equipment
- DO NOT use in wet or damp area
- DO NOT clean with liquid
- Test the device locally for safe operation before attempting to control it remotely
- Use Copper conductors only
- Installation in a closed metal enclosure degrades wireless performance and must be avoided

#### Communication Board

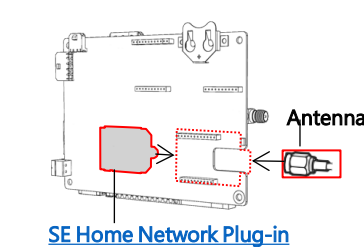

Antenna

[SE Home Network Plug-in](#)

### What's in the package

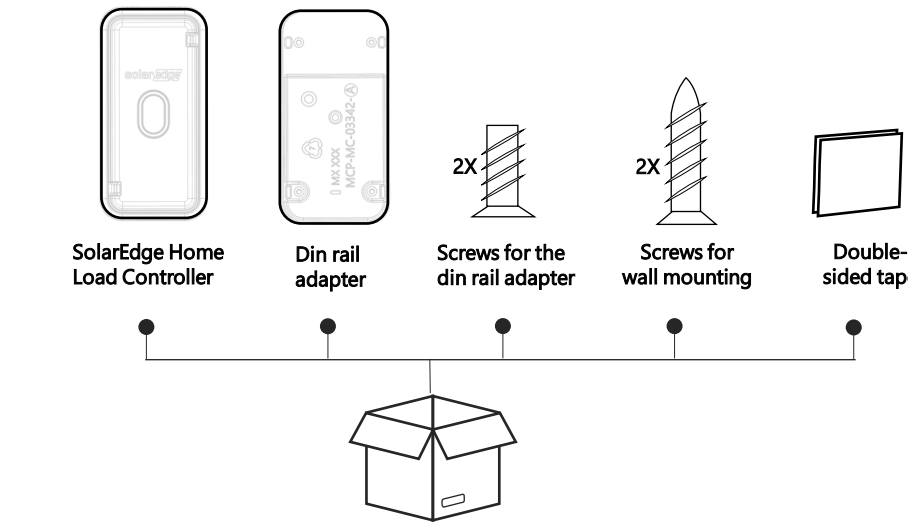

## 1 Mounting options

Choose one of the options below



Mount with screws

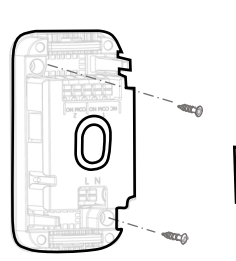

Mount with double sided tape

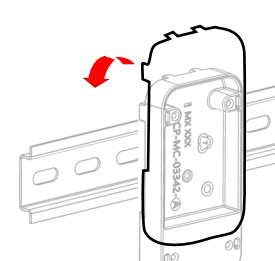

Mount with din rail adapter

**IMPORTANT:**  
Installation is allowed up to an altitude of 2000m.

## 2 Cabling

Choose one of two options below

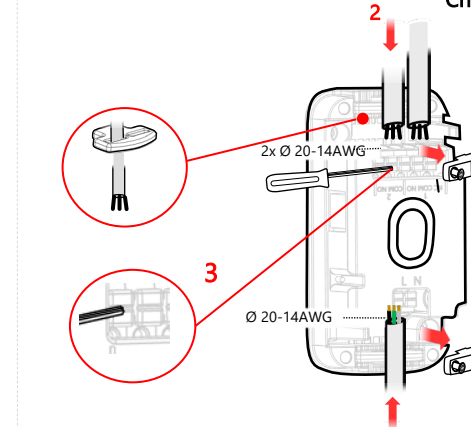

To insert cables from the top and bottom:

- Fix the cable up to Ø 0.16 inch in diameter with cable rubbers.
- Pull the through the pull relief.
- Press the top connector to the conductor.

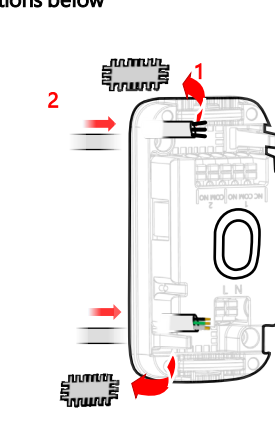

Insert cables from behind



**ELECTRICAL SHOCK HAZARD**

SolarEdge is a global leader in smart energy technology. By deploying world-class engineering capabilities and a relentless focus on innovation, we create smart energy products and solutions that power our lives and drive future progress

© SolarEdge Technologies, Ltd.  
All rights reserved.  
Version 1.4, February 2025  
Subject to change without notice.

The diagram illustrates a three-phase motor control circuit. It features a three-phase power supply (indicated by three red wavy lines) connected to a three-phase contactor. The contactor's main contacts are connected to the motor's three-phase supply. The contactor's auxiliary contacts (A1 and A2) are connected to the thermal relay's coil. The thermal relay is connected to the motor's three-phase supply. The thermal relay's main contacts are connected to the motor's three-phase supply. The thermal relay's auxiliary contacts (NO, COM, NC) are connected to the contactor's auxiliary contacts (A1 and A2). The thermal relay's main contacts are connected to the motor's three-phase supply. The thermal relay's auxiliary contacts (NO, COM, NC) are connected to the contactor's auxiliary contacts (A1 and A2). The thermal relay's main contacts are connected to the motor's three-phase supply. The thermal relay's auxiliary contacts (NO, COM, NC) are connected to the contactor's auxiliary contacts (A1 and A2).

**Caution:** Verify that the A1/A2 coil contacts match the grid connection voltage. Alternatively, an additional power supply can be used.

**Caution:**  
Verify that the A1/A2 coil contacts match the grid connection voltage. Alternatively, an additional power supply can be used.

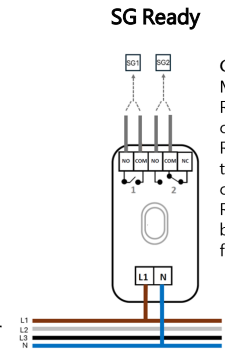

**Caution:**  
Make sure that SG Ready 4 wires are connected to the SG Ready connectors on the Heat Pump's main controller. The SG Ready wires must not be connected to the AC feed of L1 or N.

The diagram illustrates the SetApp process flow in three main steps:

- 1**: A device selection interface showing a progress bar with 'P 1 0' and a red arrow indicating a 2-second duration 'P (2 Sec)'.
- 2**: A smartphone screen displaying the 'SetApp' logo, which consists of a red square with a white gear icon.
- 3**: A vertical flowchart titled 'Commissioning' with the following steps:
  - Device manager
  - Found new devices
  - Add new devices
  - Select devices
  - Add device parameters (SG Ready only)
  - Select and configure two power levels
  - Add device
  - (SG Ready only) Perform SG Ready Test
  - Finish settings

- Press for <3 seconds to operate manual
- Hold >10 seconds to reset

LED Indications	Description
Blinking Blue	Scanning for a network or connection with Home Network is lost & load off
Blinking Green	Scanning for a network or connection with Home Network is lost & load on
Blinking Blue 30 seconds	Received request of identification
Blue	Connected to Home Network & load off
Green	Connected to Home Network & load on
Blinking Red	Error
Flickering Blue	Standby
Flickering Green 5 times	Reset done

- If in SG Ready configuration, pressing the button switches the operation from **Auto** to **Manual** (color change **Blue** to **Green**).
- To switch back to **Auto**, press the button again (color change **Green** to **Blue**). In the mySolarEdge app the **Excess PV** toggle button needs to be toggled back to **Auto**.

- Blue LED – SG Ready operation in **Auto** mode is recommended.
- Green LED – SG Ready operation in **Manual**.

Power	Value	Unit
AC Input Voltage	90-250	Vac
AC Frequency	50 / 60	Hz
Normally Open (NO) Contact Specifications	250 Vac up to 8 Aac / 30 Vdc up to 8 Adc	
Normally Close (NC) Contact Specifications	250 Vac up to 4 Aac / 30 Vdc up to 4 Adc	
Relay Switching Cycles	> 20,000	
Operating Hours	50,000	hr
Installation Altitude	2000	m
Power Consumption	< 1.5	W

 ELECTRICAL SHOCK HAZARD  
GEFAHR VON STROMSCHLÄGEN  
ELEKTRISCH SCHOKGEVAAR  
RISQUE DE CHOC ÉLECTRIQUE  
PERICOLO DI SCOSSE ELETTRICHE  
PELIGRO DE DESCARGA  
ELÉCTRICA



- Discard this product according to local regulations or send it back to SolarEdge.

If you have technical problems concerning SolarEdge products, please contact us:  
<https://www.solaredge.com/service/support>  
 Subject to change without notice.  
 Copyright © SolarEdge Inc.  
 All rights reserved.  
 December 2022.